

Catalogue No: **PF 1060**

ELDON FS PLINTH M/STEEL RAL 7022 FRONT+BACK H100 x W600mm

Enclosures and Climate Control > Standard Enclosures > Floor Standing Enclosures > Floor Standing Enclosures - Mild Steel > Floor Standing Enclosure Accessories - Suitable for Mild Steel and Stainless Steel > Plinth - Front/rear Pieces, Mild Steel



PLINTH M/STEEL RAL 7022 FRONT+BACK H100 x W600mm ELDON FS



- Powder coated mild steel RAL 7035 provides corrosion resistance in indoor applications
- Fully welded in single and double door versions, IP55 (single door IP66 with gasket kit) and IK10, resulting in exceptional strength and rigidity
- Bayable in single and double door, IP55 and IK10, allowing endless opportunities to house large equipment and provide future expandability
- Large range of accessories including plinths, baying kits, fan covers, rain hoods, lifting devices and locks
- Meets multiple standards and approvals including CE, CSA, GL, KEMA, UL and Lloyd's Register

Representative Photo Only
(actual product may vary based on configuration selections)

SPECIFICATIONS

Width	600 mm
Width, Enclosure	600 mm width
Height, Plinth	100 mm height

REFERENCES

IECEX Certificate	-
Supplier Declaration of Conformity:	-
Installation Guide:	-
User Manual:	-
Manufacturer Datasheet:	-
Manufacturer Catalogue & Product Selection:	-

Catalogue No: **PF 1060**

ELDON FS PLINTH M/STEEL RAL 7022 FRONT+BACK H100 x W600mm

Enclosures and Climate Control > Standard Enclosures > Floor Standing Enclosures > Floor Standing Enclosures - Mild Steel > Floor Standing Enclosure Accessories - Suitable for Mild Steel and Stainless Steel > Plinth - Front/rear Pieces, Mild Steel



Front view

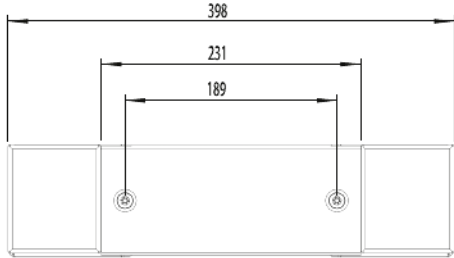

Side view

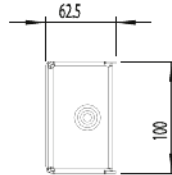

Rear view

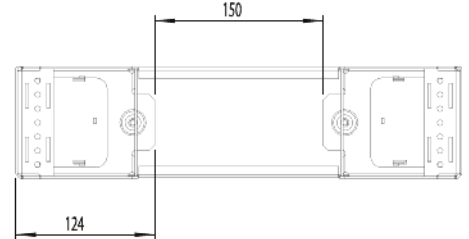

Top view

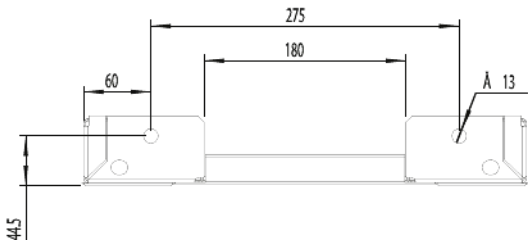

Dimension Diagram